

1

## Product Introduction

The device is mainly used to monitor the temperature of food, medicine, and other products during storage and transportation. After recording, insert it into the USB port of PC, it will automatically generate reports without any driver.

## Main Features

- Multi-use temperature measuring and recording
- Widely measuring range, high accuracy and large data memory
- Statistics available on LCD screen
- No software needed to generate PDF and CSV temperature report
- Parameter programmable by configure software

2

## Specification

Item	Parameter
Temp Scale	°C or °F
Temp Accuracy	±0.5°C (-20°C ~ +40°C), ±1.0°C (other)
Temp Range	-30°C ~ 60°C
Resolution	0.1
Capacity	32,000 readings
Startup Mode	Button or software
Interval	Optional Default: 10 mins
Start Delay	Optional Default: 30 mins
Alarm Delay	Optional Default: 10 mins
Alarm Range	Optional Default: <2°C or >8°C
Shelf Life	2 years (battery replaceable)
Report	Automatic PDF and CSV
Time Zone	UTC +0:00 (Default)
Dimensions	83mm*36mm*14mm
Weight	23g

## How to use

### a. Start Recording

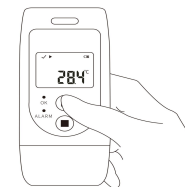

Press and hold the “▶” button for more than 3s until that the “OK” light is on and the “▶” or “WAIT” displays on the screen, which indicates the logger is started.

### b. Mark

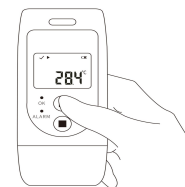

When the device is recording, press and hold the “▶” button for more than 3s, and the screen will switch to the “MARK” interface. The number of

3

“MARK” will increase by one, indicating data was marked successfully.

(Note: One record interval can mark one time only, the logger can mark 6 times in one recording trip. Under status of start delay, the mark operation is disabled.)

### c. Page Turning

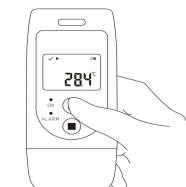

Shortly press “▶” to switch to different display interface. The interfaces shown in sequence are respectively:

Real-time Temperature → LOG → MARK → Temperature Upper Limit → Temperature Lower Limit.

### d. Stop Recording

Press and hold the “■” button for more than 3s until the “ALARM” light is on, and



the “■” display the screen, indicating stopping recording successfully.

(Note: If the logger is stopped during the status of start delay, a PDF report generated when inserted into PC but without data.)

### e. Get Report

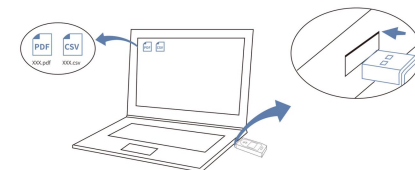

After recording, connect the device with USB port of PC, it will automatically generate PDF and CSV report.

## f. Configure The Device

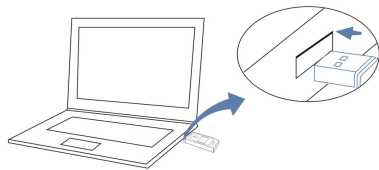

Before start using the device, you also can connect it with computer, and use configure software to programme it.

## LCD Display Instruction

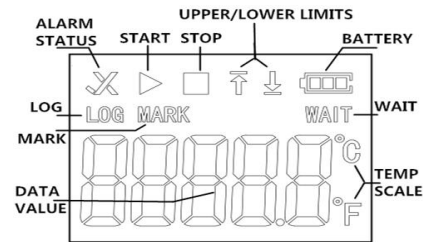

### Note:

- If the device is used for the first time or after re-configuration, the real-time temperature interface will be the initialization interface.
- Real-time temperature interface is update every 10s.

### Real-time temp interface

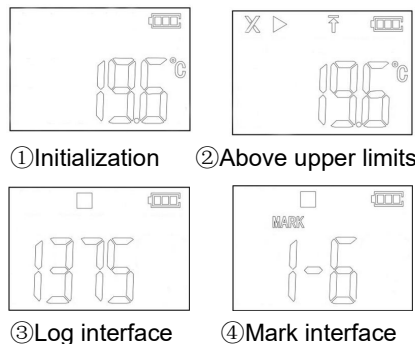

- Initialization
- Above upper limits
- Log interface
- Mark interface

8

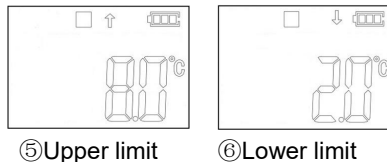

- Upper limit
- Lower limit

▶	Data logger is recording
■	Data logger has stopped recording
WAIT	Data logger is in the status of start delay
√	Temperature is within the limited range
“X” and “↑” light	Measured temperature exceeds its temperature upper limit
“X” and “↓” light	Temperature exceeds its temperature lower limit

9

## Battery Replacement

- Turn the battery cover counterclockwise to open it.

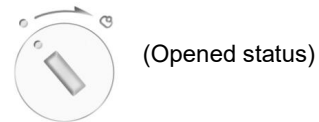

(Opened status)

- Put in a new CR2032 button battery, with the negative inward.



- Turn the battery cover clockwise to close it.



(Closed status)

10

## Battery Status Indication

Battery	Capacity
	Full
	Good
	Medium
	Low (please replace battery)

### Precautions

- Please read the manual carefully before using the logger.
- It is recommended to check the battery status before restarting the logger to ensure that the remaining battery capacity could finish the recording task.
- The LCD screen will be off after 10 seconds of inactivity. Please press the “▶” button to lighten it.

11

- Never dismantle the battery. Do not remove it if the logger is running.
- Replace old battery with a new CR2032 button cell with the negative inward.

12