

RD07(LORA Receiver) and TAG09(LORA wireless temperature sensor) User Guide

1. Add the TAG09 on the TZONE cloud platform

1.1 Website of TZONE cloud platform:<http://cloud.tzonedigital.com/>

1.2 Click the “Register”,

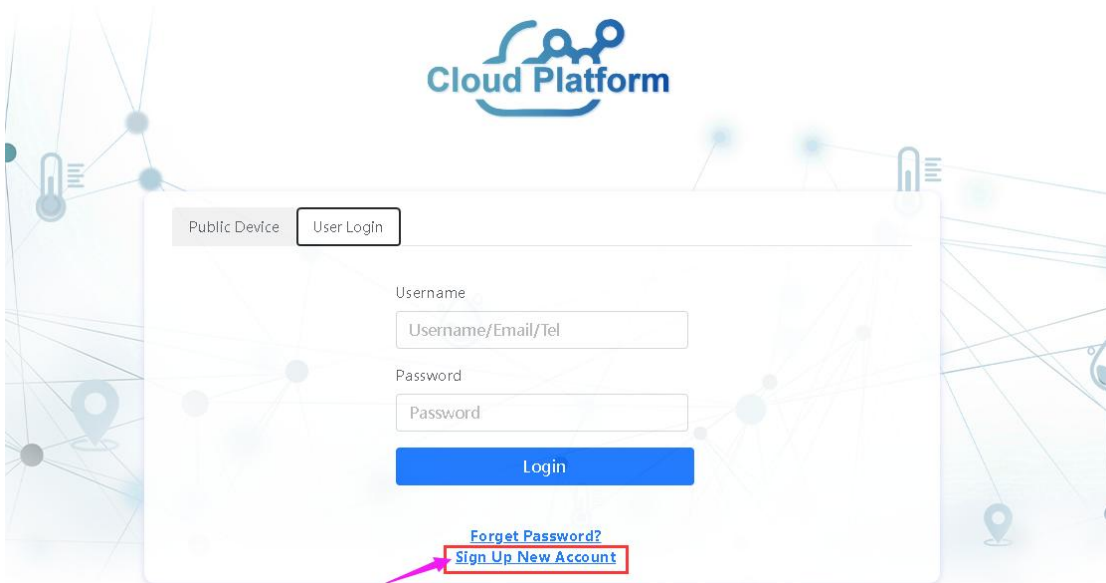

1.3 enter the registration interface. After inputting the username, email, phone number, password and etc., please click the bottom button “Register”.

1.4 Login.

Public Device User Login

Username
test100

Password
.....

Login

[Forget Password?](#)
[Sign Up New Account](#)

1.5 After login, please click the "Device management" as below, Please click "add":

Cloud Platform

test100 Standard

Overview

Real-time Monitoring

Device Management

Report

MESSAGE CENTER

Alarm Message

Exception Information

Notification Message

ACCOUNTS AND SETTINGS

<input type="checkbox"/>	5	72192062	72192062	TAG07B	Default	2023/06/06 10:23:59	2023/09/07 10:23:59	●Online			
<input type="checkbox"/>	6	180523000000030	180523000000030	TT18-4G-S	Default	2023/04/27 09:48:21	2023/07/29 09:48:21	●Offline			
<input type="checkbox"/>	7	222222222211111	222222222211111		Default	2022/12/07 11:27:18	2023/03/10 11:27:18	●Offline			
<input type="checkbox"/>	8	WIFI501B	111111111111122	TT18-4G-M	Default	2022/09/19 16:19:33	2022/12/21 16:19:33	●Offline			
<input type="checkbox"/>	9	TT18E4	868984040602068	TT18	Default	2022/07/21 15:36:54	2022/10/22 15:36:54	●Offline			
<input type="checkbox"/>	10	Tag11	10220002	DTU01	Default	2022/06/02 17:36:32	2022/09/03 17:36:32	●Offline			

Add **Delete**

< 1 2 3 4 ... 16 >

1.6 Please edit the device name, device ID, Group, remarks. you can also select the location of the device to be placed in the map (initial location) and click "Save" .

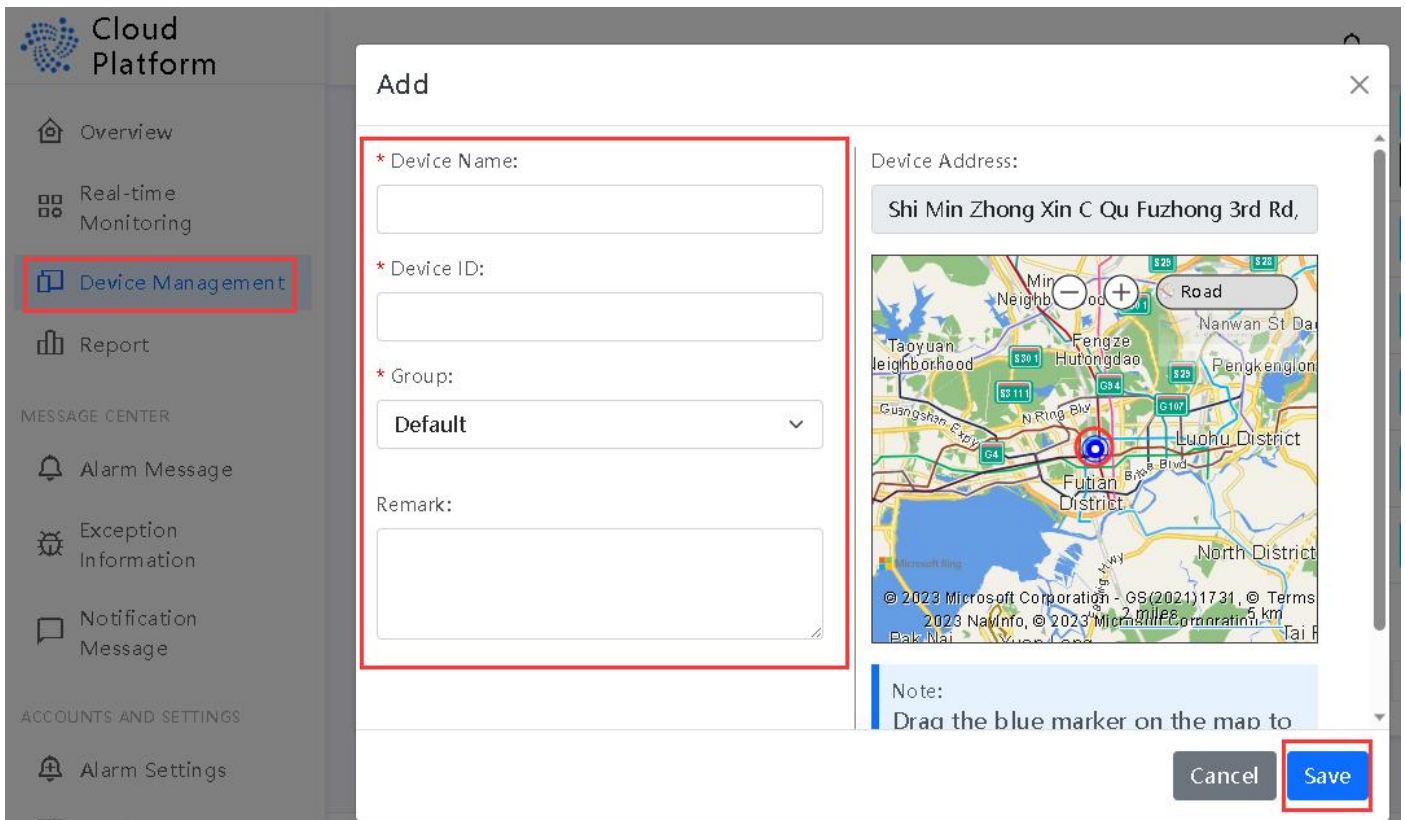

1.7 When the message "Add succeeded" is displayed, turn on the gateway, and the TAG09 will be automatically sent.

2. How to start the RD07 (LoRa gateway)/TAG09

2.1 Insert the SIM card.



2.2 Install the RF and GSM antenna. Connect the device with the power supply.



2.3 Turn on the device. (Left-on, right-off)



2.4 The machine starts working when three LED lights flash at the same time. The data is default to be sent to TZONE cloud platform automatically.

If your SIM card is designated to be the one SIM card operator, please configure the device with APN, If the APN is configured successfully, the data will be sent to TZONE cloud platform. (you can set it by configuring software)

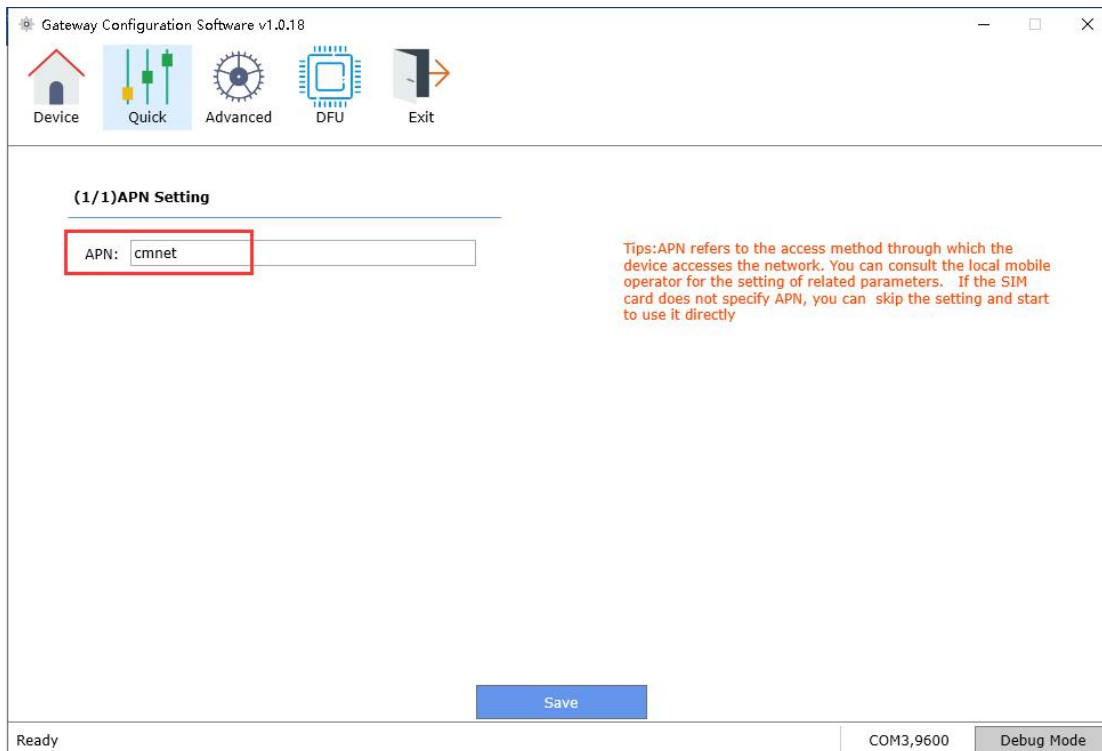

The status of LED light flashing:

Blue light: The light will be on for 0.1 second if the data received.

Green light: If login GSM network, the light will be on 0.1 second and off 2.9 seconds
If login GPRS network, the light will be on 0.1 second and off 0.9 seconds

Red light: No power supply connected, the light will be on every 2 seconds. If the power supply is connected, the light will be always on.

2.6 TAG09 is turn on by default and data will be sent directly to the gateway

Please connect the antenna, TAG09 is enabled by default and automatically sends a data to the Lora gateway every 15 minutes. If you need to send data to the gateway quickly, you can directly press the one-second button.



3. Access to TAG09 data on TZONE Cloud platform

Two ways to view data.

Please into TZONE Cloud platform (<http://cloud.tzonedigital.com/>).

3.1 Enter the device ID to query



Device ID : 09000001

Temperature 25.9°C	Humidity --%	Battery 5%	Light --lux
-----------------------	-----------------	---------------	----------------

2023/08/14 15:53:26

Chart

2023-08-10 15:07 2023/08/17 15:07 View Download

Chart
2023-08-10 15:05 ~ 2023-08-13 04:43

3.2 Login query

Cloud Platform

Real-time Monitoring

TT18 4G -S test111 1805230000000313.62V/20% 26.3°C 58.5% Bright 2023/08/04 19:37:31 → View Details	TT18 2G 699999999999990 3.41V/5% 28.4°C 54.8% Off 2023/08/04 19:41:36 → View Details	08211915 08211915 3.63V/100% 27.3°C --% -84dBm 2023/08/04 19:49:00 → View Details
62209902 62209902 3.55V/80% 25.4°C 56% -43dBm 2023/08/04 19:48:52	72192062 72192062 3.31V/10% 30°C 69% -71dBm 2023/08/04 19:49:03	TAG08 LORAWAN 373431387D386A12 % --°C --% 0000-00-00 00:00

Copyright © 2023 Tzone Digital Technology Co., Ltd

3.3 If you do not need to enter the device ID directly query function, you can enter the "Account ID" and select "Security and Privacy setting" to disable this function.

ACCOUNTS AND SETTINGS

- Alarm Settings
- Service
- Account ID**
- My Account
- User Management
- Grouping and permissions
- Security and privacy settings**
- Login Information
- Operation Log

Security and privacy settings | Account ID > Security and privacy settings

Shared data

Enable

Note:

1. Enable public data, you can enter the device ID on the homepage to directly query the device data.

Save Settings